

ALTERNATE METHODS OF SECURING VERTICAL STAY WIRE TO THE HORIZONTAL WIRE OF THE FABRIC.

DETAIL "A"

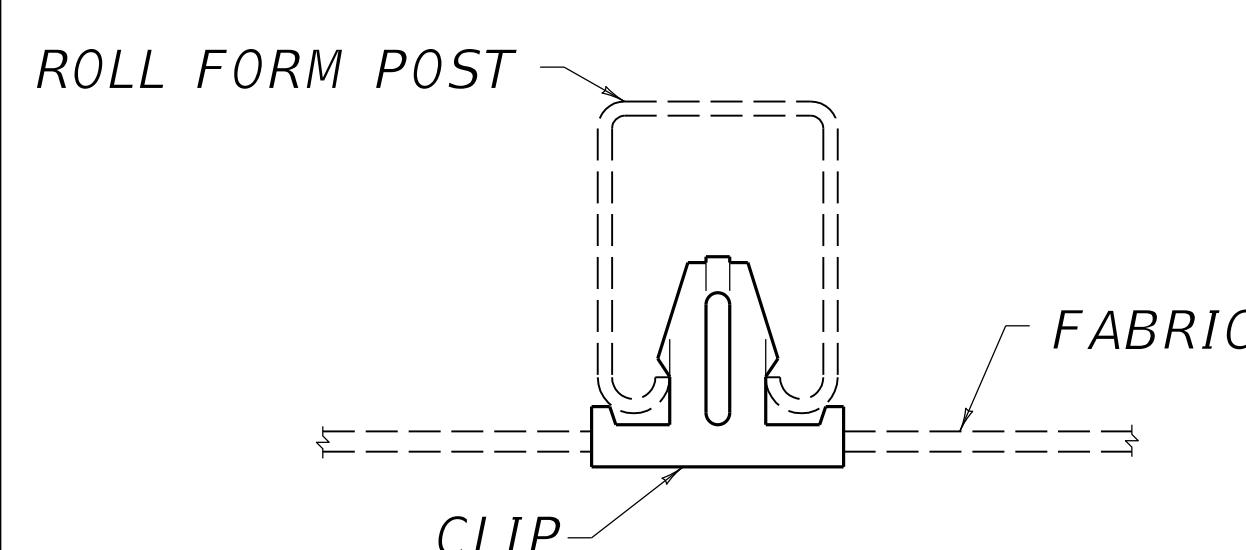

PLAN VIEW OF CLIP INSTALLED IN ROLL FORM POST

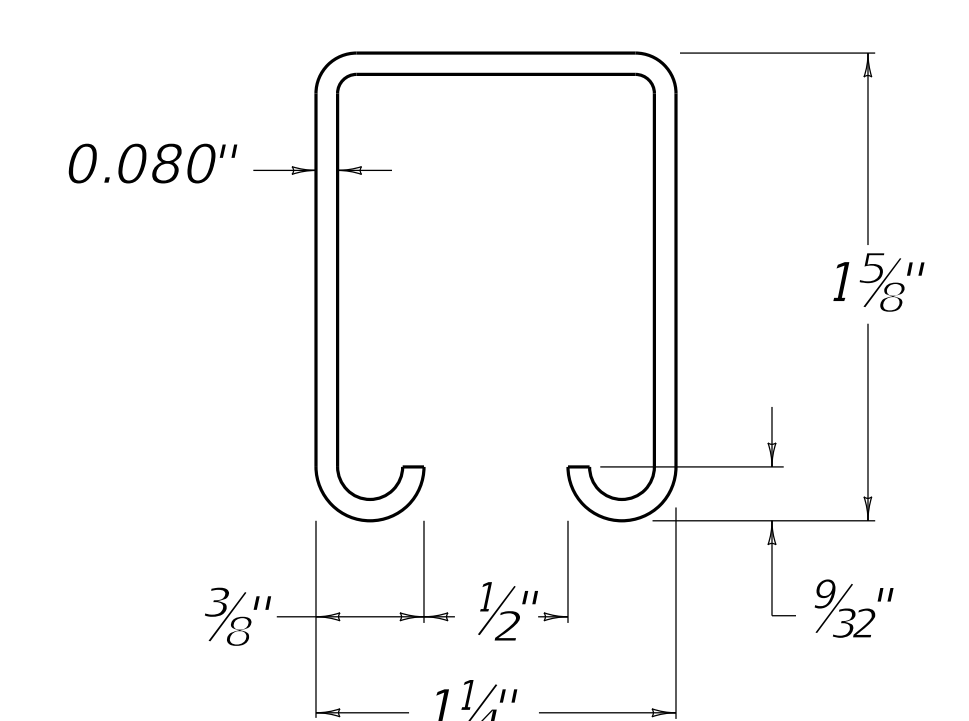

PLAN VIEW OF ROLL FORM POST

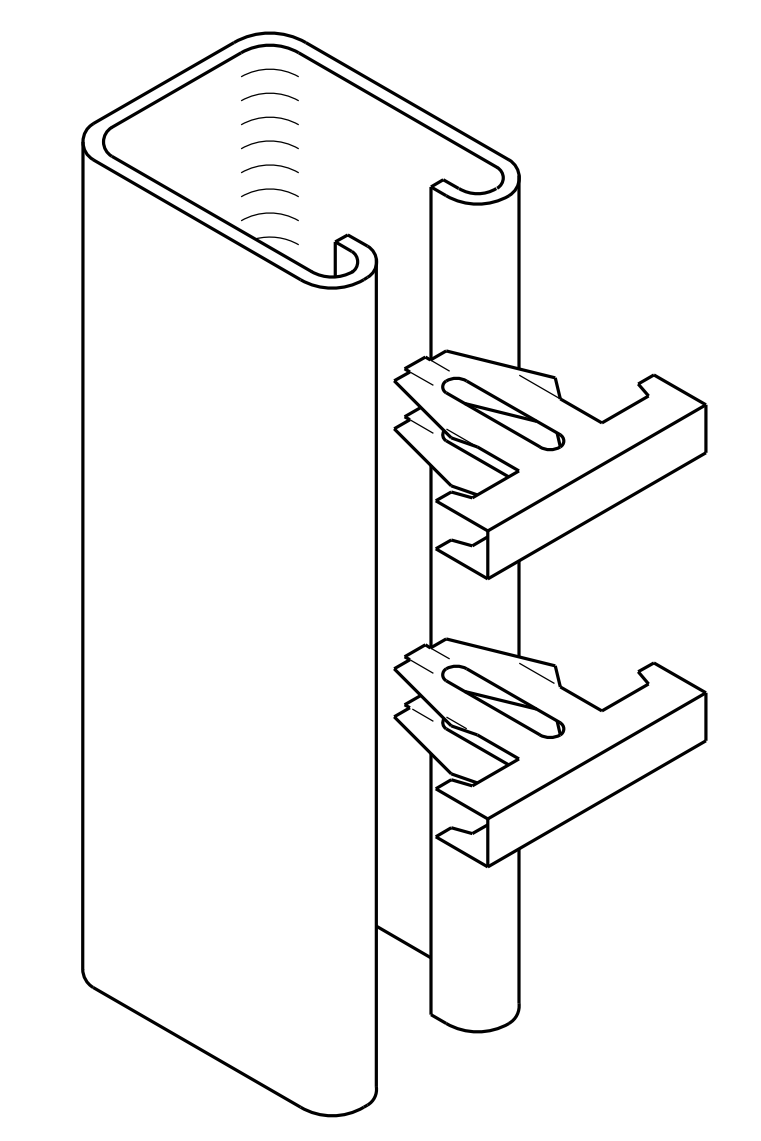

ISOMETRIC EXPLODED VIEW OF ROLL FORM POST AND CLIPS  
CLIPS SHALL BE SPRING STEEL ALUMINUM - FINISHED

~ NOTES ~

- BID ITEMS AND UNIT TO BID
- |                         |      |
|-------------------------|------|
| FENCE-WOVEN WIRE TYPE 1 | LF   |
| CONCRETE-CLASS B        | CUYD |
1. STUDDED "T" POST CONFORMING TO ASTM A702 AT 1.33 LBS. PER FOOT - OR - ROLL FORM POST AT 1.40 LBS. PER FOOT (SEE DETAIL)
  2. NOT REQUIRED FOR ROLL FORM POST.
  3. WOVEN-WIRE FABRIC SHALL BE EITHER ALUMINUM-COATED STEEL NO. 1047-6-9 OR ZINC-COATED STEEL NO. 1047-6-9.
  4. ALL FENCE FITTINGS SHALL COMPLY WITH ASTM F626.
  5. NPS = NOMINAL PIPE SIZE - ASTM F1083 AND F1043 (HEAVY INDUSTRIAL FENCE) SHALL GOVERN.

REVISION DATE: 12/01/2015  
REVISION NUMBER: 0

SUBMITTED: 12-01-2015  
DIVISION DIRECTOR: [Signature]  
DATE: 12-01-2015  
APPROVED: [Signature]  
STATE HIGHWAY ENGINEER: [Signature]

FENCES & GATES